

[illegible]

River passenger & restaurant vessels are favorite for tourists visiting Bangkok – the most beautiful capital city in South East Asia. Vessels of 50-100 m long have become popular sailing between river piers on West and East bank of the Chao Phraya River. Navis Consult is the pioneer team to design and supervise the building works of such craft for the past 25 years. The typical size of the vessel is 53.00 m long, 11.00 m wide and 2.10 m deep. The main engine power is 2x500 BHP. The operating speed is about 10 knots.

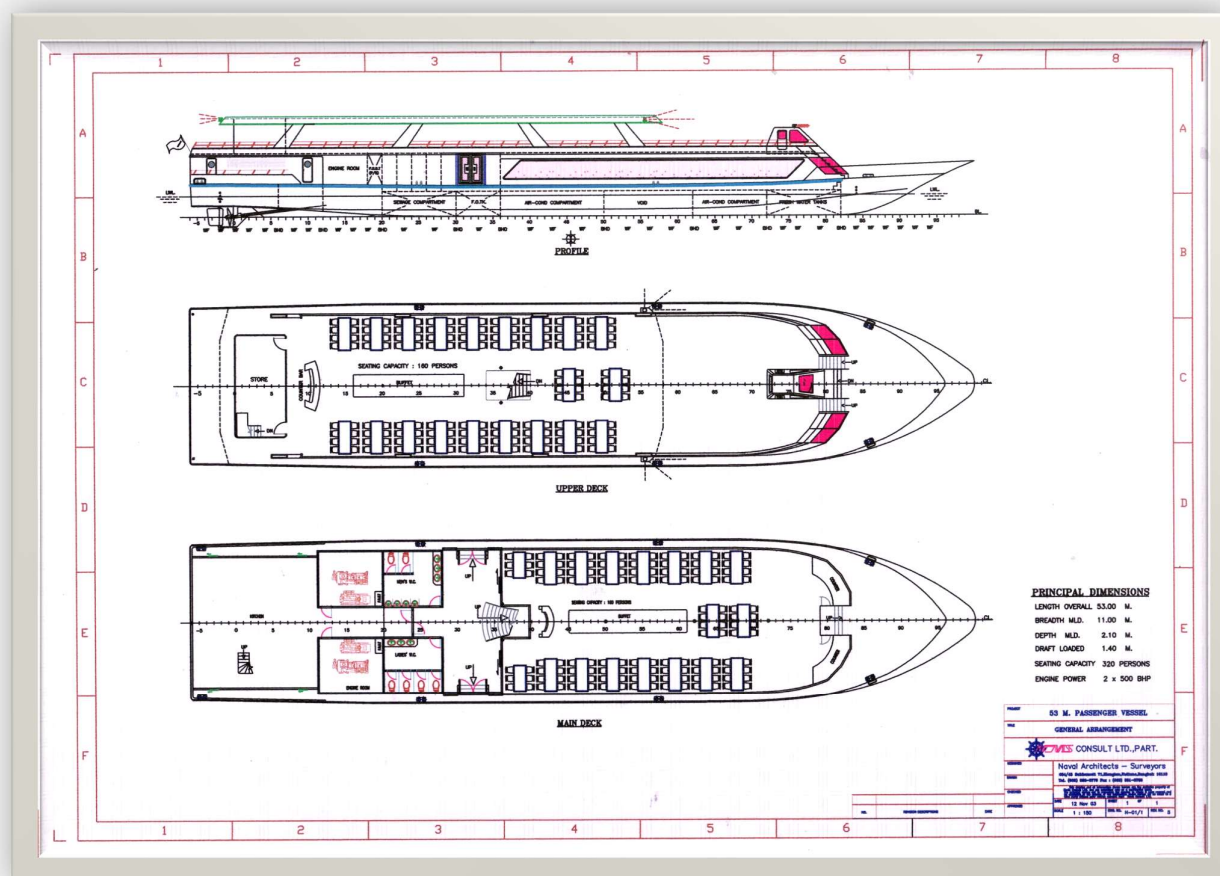

Currently NAVIS had designed and supervised various river passenger & restaurant vessels. The typical size of the vessel is 25 – 80 m long. One of the earliest designs is the passenger & restaurant “QUEEN VICTORIA”. The vessel is 33.00 m long, 10.00 m wide and 1.85 m deep. The main engine power is 2x350 BHP. The main generator is 50 KW. The operating speed is about 10 knots. The total capacity of passenger and crew is 150 persons.

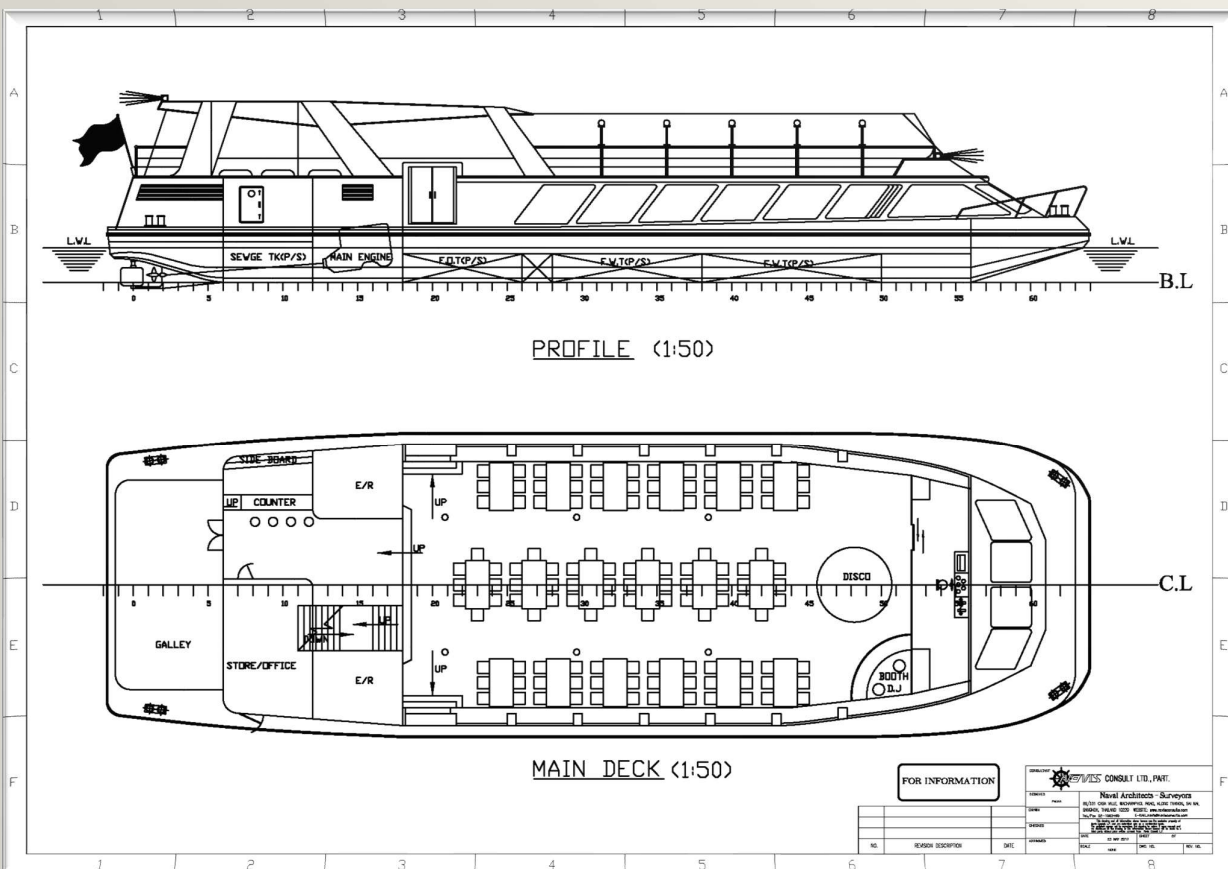



NAVIS had designed and supervised the construction of a sailing junk “SRI MAHA SAMUT” which imitates an ancient Chinese junk . The vessel is fitted with various display items used as a floating museum for tourists to visit. The vessel is 38.30 m long, 9.00 m wide and 3.30 m deep. The main engine power is 400 BHP. The main generator is 150 KW. The operating speed is about 8 knots. The total capacity of passenger and crew is 200 persons.

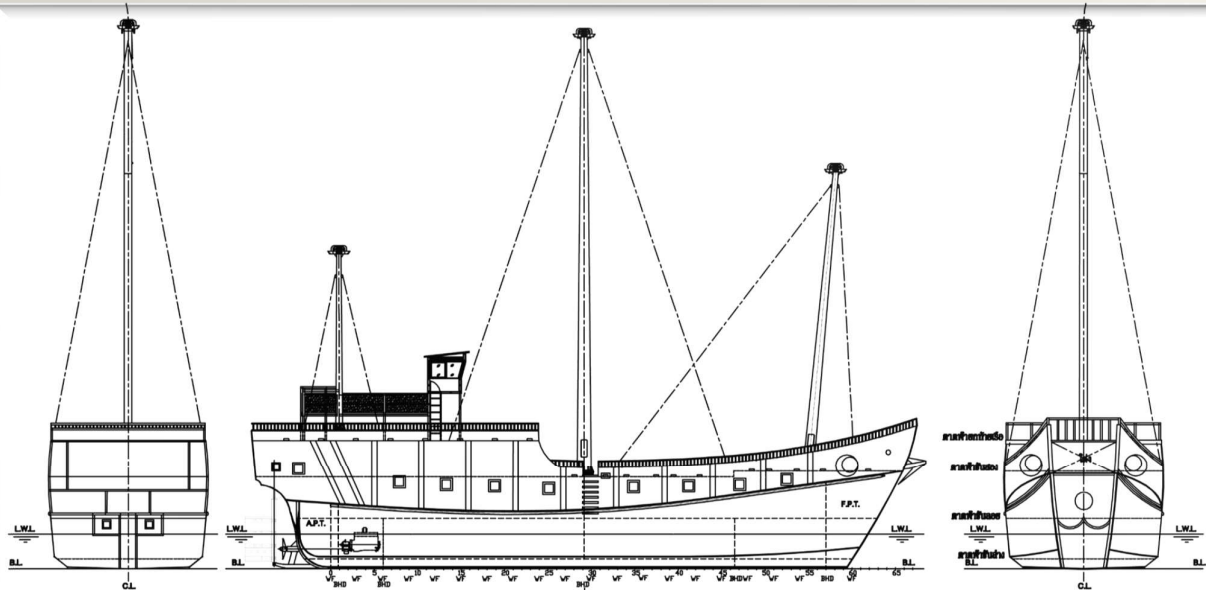

รูปท้ายเรือ

รูปด้านซ้าย

รูปหัวเรือ

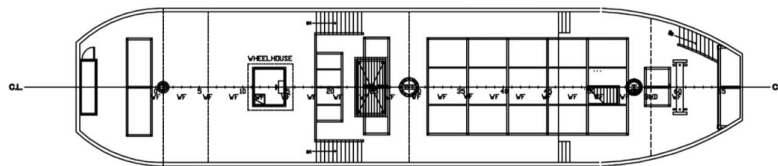

รูปด้านบน

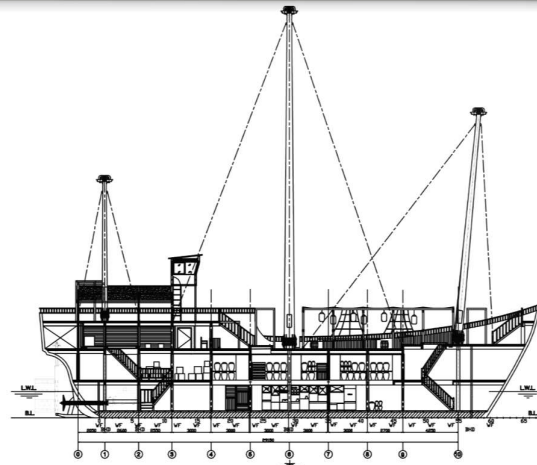

รูปภาคตัดภายใน

